



Howard Building, Two bedroom. Chelsea Bridge Wharf SW8

£1,525,000  
[www.luxecorp.co.th](http://www.luxecorp.co.th)



## Howard Building, Two bedroom. Chelsea Bridge Wharf

£1,525,000

A fantastic two bedroom apartment located on the third floor in the Howard Building at Chelsea Bridge Wharf. This two bedroom apartment has amazing views overlooking the wonderful River Thames, complete with an enormous terrace. Open plan kitchen/living area. Master bedroom includes an en suite bathroom. Spacious second bedroom and separate shower room/guest wc. Plenty of storage space throughout and has a 'comfort cooling system'. Chelsea Bridge Wharf is London's most glamorous riverside development just 0.75 miles from Sloane Square and adjacent to the wide open spaces of Battersea Park and the River Thames. There is a 24 hour concierge service and secure underground car parking is available (extra cost). A luxury four star hotel is located at the development.

Leasehold: 988 years      Service Charge: £4,261 per year (approximately)

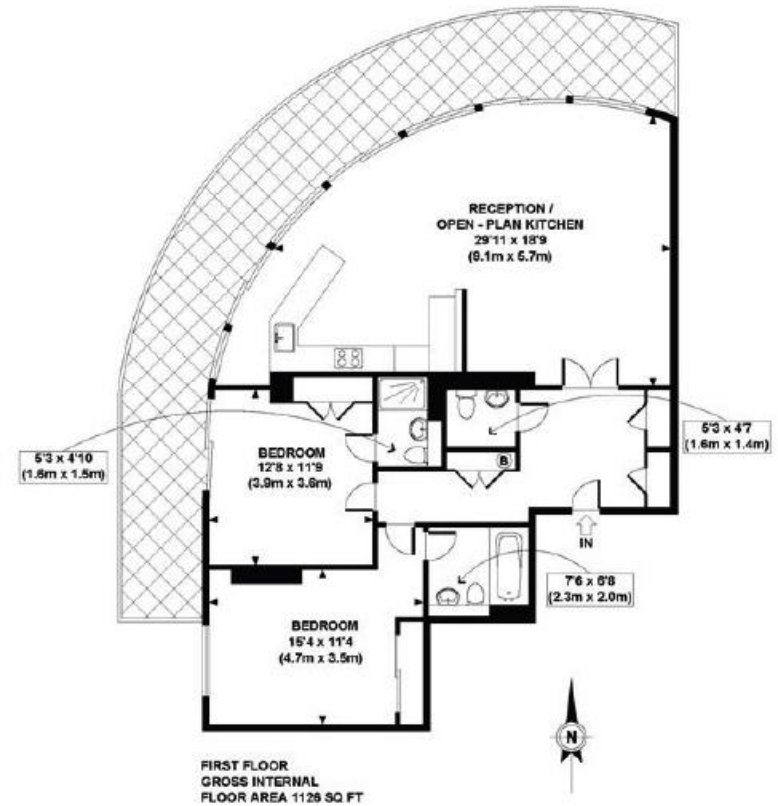

APPROX. GROSS INTERNAL FLOOR AREA 1126 SQ FT / 105 SQ M  
Ref: BGGJCBW - Copyright [photo-plan.co.uk](http://photo-plan.co.uk)  
Floorplans are for identification and guideline purposes only, not to scale.  
Compliant with RICS code of measuring practice.

For Further Information Please Contact us : Tel (+668) 1456 3422 [www.luxecorp.co.th](http://www.luxecorp.co.th)